



### Directions:

Seneca Manor Drive runs between Seneca Avenue and Hudson Avenue, north of route 104 and south of Ridge Road East.

501 Seneca Manor Dr.  
Rochester, NY 14621

**585-338-3400**

FAX: 585-342-2260

TDD-TTY 1-800-421-1220

email: KeelerPark@coniferllc.com

www.Keelerparkapartments.coniferliving.com

Office Hours:

Monday-Friday: 9:00 AM - 4:30 PM



**conifer**

*building opportunities, achieving dreams*

www.coniferliving.com



## Keeler Park

*coniferLiving*

*Rochester, NY*

Apartment Community

## Comfort & Style

Conveniently located near all that Rochester has to offer, Keeler Park is a great place to call home. Relax on park benches in the sun, grill outside, and enjoy the playground. Visit today and see all that Keeler Park has to offer. Keeler Park...more than you expect.

# Keeler Park

coniferLiving  
Rochester, NY

## Amenities and Features that enhance your comfort and enjoyment.

- Community room
- Laundry facilities
- On-site convenience store
- Hair salon
- Computer lab
- Off-street parking
- Playground
- Picnic area
- Located on city bus line
- Free bus service to supermarket
- Lounge
- Library
- Bingo
- 24 hour emergency maintenance
- Friendly, professional management on-site
- Before and after school children's program (city school district)
- Monthly rent includes all utilities, appliances
- Rental assistance for those who qualify

12 month lease available  
Security deposit equal to one month's rent

## Floor Plans

One, two, and three bedroom apartments.  
Just right for families of all sizes.

### One Bedroom

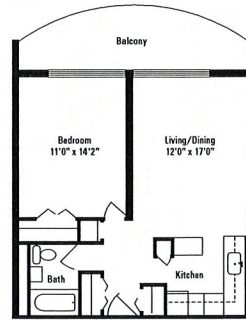

### Two Bedroom

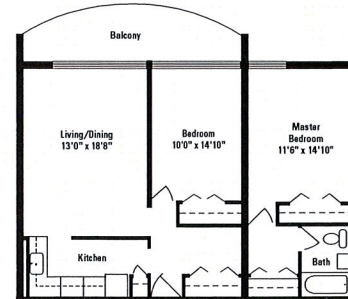

### Three Bedroom

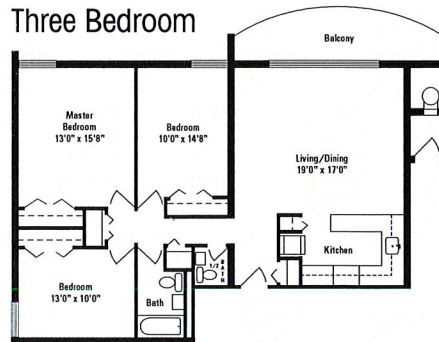

Keeler Park Apartments is conveniently located near supermarkets, banks, hospitals, Super Walmart, Seneca Zoo, Durand Eastman Park, and Irondequoit Mall. Everything you need is located right near your door step!